



**CHICAGO, ROCK ISLAND & PACIFIC R. R.**

**THE GREAT CONNECTING LINK**

It is the only line from Chicago to the West, and the only line from the West to Chicago. It is the only line that runs through the heart of the country, and the only line that is the most direct and the most comfortable.

It is the only line that runs from Chicago to the West, and the only line from the West to Chicago. It is the only line that runs through the heart of the country, and the only line that is the most direct and the most comfortable.

**U. P. R. R.**

Until further notice trains will leave and arrive at Ogden daily, as follows:

Train	Leave	Arrive
Daily Express	10:30 a.m.	6:15 p.m.
Mixed	1:00 p.m.	8:00 p.m.
Freight	3:30 p.m.	10:00 p.m.

At Ogden with stages for Sweetwater, etc.

At Cheyenne with the Colorado Division of the Union Pacific for Denver, Leadville, Central, Black Hawk, and all other intermediate points and stages for Colorado.

At Cheyenne with the Colorado Division of the Union Pacific for Denver, Leadville, Central, Black Hawk, and all other intermediate points and stages for Colorado.

**UTAH CENTRAL RAILROAD**

**PIONEER LINE OF UTAH.**

To take effect January 20th, 1881.

NAME OF STATION	No. 1	No. 2	No. 3	No. 4	No. 5
Salt Lake	1:00	2:00	3:00	4:00	5:00
Provo	1:15	2:15	3:15	4:15	5:15
Payson	1:30	2:30	3:30	4:30	5:30
Alton	1:45	2:45	3:45	4:45	5:45
Richmond	2:00	3:00	4:00	5:00	6:00
Albany	2:15	3:15	4:15	5:15	6:15
Albany	2:30	3:30	4:30	5:30	6:30
Albany	2:45	3:45	4:45	5:45	6:45
Albany	3:00	4:00	5:00	6:00	7:00

**UTAH SOUTHERN RAILROAD**

To take effect June 1st, 1881.

NAME OF STATION	No. 1	No. 2	No. 3	No. 4	No. 5
Salt Lake	1:00	2:00	3:00	4:00	5:00
Provo	1:15	2:15	3:15	4:15	5:15
Payson	1:30	2:30	3:30	4:30	5:30
Alton	1:45	2:45	3:45	4:45	5:45
Richmond	2:00	3:00	4:00	5:00	6:00
Albany	2:15	3:15	4:15	5:15	6:15
Albany	2:30	3:30	4:30	5:30	6:30
Albany	2:45	3:45	4:45	5:45	6:45
Albany	3:00	4:00	5:00	6:00	7:00

**UTAH SOUTHERN RAILROAD**

To take effect June 1st, 1881.

NAME OF STATION	No. 1	No. 2	No. 3	No. 4	No. 5
Salt Lake	1:00	2:00	3:00	4:00	5:00
Provo	1:15	2:15	3:15	4:15	5:15
Payson	1:30	2:30	3:30	4:30	5:30
Alton	1:45	2:45	3:45	4:45	5:45
Richmond	2:00	3:00	4:00	5:00	6:00
Albany	2:15	3:15	4:15	5:15	6:15
Albany	2:30	3:30	4:30	5:30	6:30
Albany	2:45	3:45	4:45	5:45	6:45
Albany	3:00	4:00	5:00	6:00	7:00

**UTAH SOUTHERN RAILROAD**

To take effect June 1st, 1881.

NAME OF STATION	No. 1	No. 2	No. 3	No. 4	No. 5
Salt Lake	1:00	2:00	3:00	4:00	5:00
Provo	1:15	2:15	3:15	4:15	5:15
Payson	1:30	2:30	3:30	4:30	5:30
Alton	1:45	2:45	3:45	4:45	5:45
Richmond	2:00	3:00	4:00	5:00	6:00
Albany	2:15	3:15	4:15	5:15	6:15
Albany	2:30	3:30	4:30	5:30	6:30
Albany	2:45	3:45	4:45	5:45	6:45
Albany	3:00	4:00	5:00	6:00	7:00

**EVENING NEWS.**

Thursday, April 28, 1881.

**JUAB STAKE CONFERENCE.**

On Friday April 15th, 1881, the Juab Stake Conference commenced. At 10 a. m. the Primaries assembled at the Nephri Tabernacle. The Nephri North and South Wards were fully represented. The Levan and Mona parishes. The children sang very sweetly.

After prayer the presidents of the wards reported the condition of their ward primaries which was very satisfactory.

A prepared programme demonstrated the improvement in the children's reports. The Primary authorities were presented by Pres. Geo. Tensdale, both of the Stake and the Levan which were fully sustained. The programme was a very enjoyable time.

In the afternoon our good sisters held their quarterly conference, the tabernacle choir being in attendance under the able leadership of Prof. J. R. Dalton.

After opening services very interesting reports and remarks were made showing that our sisters take great interest in the latter-day work. The relief authorities were sustained for the Stake and Wards.

In the evening the quarterly Priesthood meeting was held. Reports from the various groups were received, good instructions given, a profitable time.

On Saturday morning at 10 a. m. there was a very good attendance of the people. After opening services the Bishops reported their wards and themselves in the enjoyment of the spirit of the gospel.

Elder Edward Kay, recently returned from a mission to England, gave an interesting report in a graphic account of his labors and mission, closing with an earnest testimony.

At 2 p. m. after devotional services President Joseph F. Smith read the statistical report.

Elder John Kinkie, Presidents Joel Grover and K. H. Brown occupied the afternoon preaching the gospel and exhorting to faithfulness and good works.

President Tensdale made a few closing remarks on the philosophy of the Mormon religion.

In the evening there was a crowded attendance. The Young Men's and Ladies' Mutual Improvement held their conference in the afternoon. Very satisfactory reports were given by the superintendents of Stake and Wards.

President Howard Spencer of Kanab, and Elder G. H. Cannon of Orderville, made some very encouraging remarks, and the Stake and Ward authorities of the U. T. M. and Y. L. A. were presented and sustained.

On Sunday morning at 10, the Sabbath schools held their conference. The teachers reported a very good attendance. The children were very bright, joyous countenances assembled together in conference. The teachers occupied the end of the forenoon in the choir, under the guidance of the worthy friend, Charles Kinkie, charmed us with their sweet music. Reports were given by the County and Ward superintendents showing a very interesting being taken by earnest men and women in this laudable work.

Superintendent Tensdale was delighted to meet President George Q. Cannon at the depot, and escort him to the meeting. He arrived at the choir were singing one of their most harmonious hymns, and were introduced to them, addressed them in a most affectionate and fatherly manner. It was a time long to be remembered.

At 2 p. m. there was not room for the congregation in the Tabernacle, the doors of the vestry were thrown open and it was soon filled. After the usual exercises, Bishop Hunter's singing school reported. It showed an increase of receipts for the past year of \$1,800. The financial report was given.

President George Q. Cannon occupied the rest of the time in a very powerful and interesting manner.

It was resolved to continue our Conference until Monday noon.

In the evening President Cannon addressed the young people. The meeting was under the auspices of the Y. M. and Y. L. M. I. Associations, Stake Superintendent Thos. Crawley presiding. The Sabbath school choir was in attendance, the house was again crowded, and all were deeply interested.

Monday morning, at 9 o'clock, President Cannon, upon invitation met with the presiding authorities of the Stake, at which meeting much valuable instruction was imparted.

Elder Thomas Crawley was ordained to the High Priesthood.

At 10:30 a. m. Conference continued. After devotional exercises the Church and Stake authorities were presented and sustained.

Presidents George Q. Cannon and George Tensdale occupied the time in general instructions and exhortations.

W. A. C. BRYAN, Clerk.

**CHICAGO & NORTH-WESTERN RAILWAY.**

Is the Oldest Best Constructed Best Equipped and most Improved.

**LEADING RAILWAY**

OF THE WEST AND NORTHWEST!

It is the Short, Sure and Safe Route between COUNCIL BLUFFS AND CHICAGO, MILWAUKEE

And all points East, such as Niagara Falls, New York, Philadelphia, Boston, Washington, Baltimore, Pittsburgh, Central, Cleveland, Detroit, etc.

At Council Bluffs the Trains of the Chicago & North-Western and the U. T. M. depart from the same joint Union Depot.

At Chicago, close connections are made with the Lake Shore, Michigan Central, Baltimore & Ohio, Erie, Pennsylvania, Rock Island, Illinois Central, and the Kansas and Oklahoma routes.

**PULLMAN PALACE DRAWING ROOM CARS**

Are run on all through trains of the road.

**COUNCIL BLUFFS AND CHICAGO**

Upon which run the celebrated PULLMAN HOTEL DINING CARS

Visit these Ticket Agents selling you tickets to visit them. Examine your tickets, and read to see if they do not read over the Chicago & North-Western and Rock Island & Pacific Railroad, with the Central, Union Pacific, and the Lake Shore, Michigan Central, Baltimore & Ohio, Erie, Pennsylvania, Rock Island, Illinois Central, and the Kansas and Oklahoma routes.

At Council Bluffs, close connections are made with the Lake Shore, Michigan Central, Baltimore & Ohio, Erie, Pennsylvania, Rock Island, Illinois Central, and the Kansas and Oklahoma routes.

At Chicago, close connections are made with the Lake Shore, Michigan Central, Baltimore & Ohio, Erie, Pennsylvania, Rock Island, Illinois Central, and the Kansas and Oklahoma routes.

At Council Bluffs, close connections are made with the Lake Shore, Michigan Central, Baltimore & Ohio, Erie, Pennsylvania, Rock Island, Illinois Central, and the Kansas and Oklahoma routes.

At Chicago, close connections are made with the Lake Shore, Michigan Central, Baltimore & Ohio, Erie, Pennsylvania, Rock Island, Illinois Central, and the Kansas and Oklahoma routes.

**LUMBER YARD**

**PLANING MILL!**

Reduction in Prices!

Utah Red and White Pine of all kinds, Eastern White Pine, California Redwood, Oak, Fir, Spruce, Cedar, and all other kinds of lumber.

**SHINGLES.**

Red and White Rustic, Ceiling, Siding, Lath, Pickets, Flooring.

**SASH, DOORS, BLINDS,**

**Mouldings in Great Variety.**

Frames of all kinds Made to Order Very Cheap!

**WINDOW GLASS.**

Using large quantities of glass, and dealing directly with the manufacturers in California, we are enabled to keep a large stock on hand, and sell at very low rates.

**WOOD TURNING OF ALL KINDS.**

**LATIMER, TAYLOR & CO.,**

**ONE BLOCK EAST OF DEPOT.**

**Swallowing Poison.**

Swallowing and inhaling the noxious vapors generated by Catarrh, poison not only the nasal organs, but the stomach and lungs. No merely local remedy, like jabs and washes, can reach the seat of the disease. The only cure is the use of the powerful medicine known as "The Catarrh Cure." This medicine is a powerful antiseptic, and it is the only medicine that can reach the seat of the disease. It is the only medicine that can reach the seat of the disease. It is the only medicine that can reach the seat of the disease.

**CHICAGO TO PITTSBURGH, BALTIMORE, WASHINGTON, PHILADELPHIA AND NEW YORK.**

**GREAT SHORT LINE**

**TO BOSTON**

Reaches all points in Pennsylvania and New Jersey.

**PULLMAN PALACE CARS**

On all EXPRESS TRAINS.

**MAGNIFICENT CARS**

Equipped with the celebrated Washington Patent Safety Platform.

**Elegant Eating Houses**

With ample time for meals.

**EXPRESS TRAINS**

Leave Chicago as follows:

Train	Leave	Arrive
Chicago Express	1:00 p.m.	6:00 p.m.
Chicago Express	1:15 p.m.	6:15 p.m.
Chicago Express	1:30 p.m.	6:30 p.m.
Chicago Express	1:45 p.m.	6:45 p.m.
Chicago Express	2:00 p.m.	7:00 p.m.
Chicago Express	2:15 p.m.	7:15 p.m.
Chicago Express	2:30 p.m.	7:30 p.m.
Chicago Express	2:45 p.m.	7:45 p.m.
Chicago Express	3:00 p.m.	8:00 p.m.

**SCOVILL'S BLOOD & LIVER SYRUP.**

A peerless remedy for Scrofula, White Swelling, Cancer, Erysipelas, Gout, Bilious Complaints, Rheumatism, etc. It is a Compound of vegetable extracts, the chief of which are SASSAPILLA and STILLINGIA. The cure effected by SCOVILL'S BLOOD & LIVER SYRUP is absolute, and their record is undisputed by failures. For sale by all Druggists.

**KELLINGER'S INFALLIBLE LINIMENT**

Has been over 20 years a household remedy for all Nervous Diseases, Rheumatism, Sciatica, Swellings, Sprains, Bruises, Burns, Itch, and all other skin diseases. It is a Pure and Powerful Remedy, and is never sold at a cheap price.

**DUNN'S CATARRH CURE**

Cures all forms of Catarrh, Cold in the Head, Hoarseness, and prevents Bronchitis, Croup, and all other throat diseases. It is a Pure and Powerful Remedy, and is never sold at a cheap price.

**Mott's Liver Pills.**

THE GREAT VEGETABLE CATHARTIC.

**DR. ROBERT'S VEGETABLE WORM SYRUP**

Instantly cures WORMS, and restores the system to health.

**SCOVILL'S BLOOD & LIVER SYRUP.**

A peerless remedy for Scrofula, White Swelling, Cancer, Erysipelas, Gout, Bilious Complaints, Rheumatism, etc. It is a Compound of vegetable extracts, the chief of which are SASSAPILLA and STILLINGIA. The cure effected by SCOVILL'S BLOOD & LIVER SYRUP is absolute, and their record is undisputed by failures. For sale by all Druggists.

**KELLINGER'S INFALLIBLE LINIMENT**

Has been over 20 years a household remedy for all Nervous Diseases, Rheumatism, Sciatica, Swellings, Sprains, Bruises, Burns, Itch, and all other skin diseases. It is a Pure and Powerful Remedy, and is never sold at a cheap price.

**DUNN'S CATARRH CURE**

Cures all forms of Catarrh, Cold in the Head, Hoarseness, and prevents Bronchitis, Croup, and all other throat diseases. It is a Pure and Powerful Remedy, and is never sold at a cheap price.

**Mott's Liver Pills.**

THE GREAT VEGETABLE CATHARTIC.

**DR. ROBERT'S VEGETABLE WORM SYRUP**

Instantly cures WORMS, and restores the system to health.

**ROYAL BAKING POWDER**

Absolutely Pure.

Made from Grape Cream Tartar. No other preparation makes such light, airy, tender, and delicious bread. Can be used by Dispensaries without fear of the risk resulting from heavy indigestible food. Sold by all Grocers.

ROYAL BAKING POWDER CO., New York.

**CHOICE MEATS!**

FRESH AND JUICY. THE BEST TRY market affords, always on hand at the Family Meat Market, just west of 10th St. Salt Lake City.

JAS. WILLIAMSON, Proprietor.

**OUR SPECIAL INDUCEMENTS**

Are offered every day to Cash Buyers, or any other Gifted Fellow, who will find the BAIN WAGON DEPOT.

The place to buy the Best, most Elegant and Substantial.

**Spring Wagons**

In the Market, also

**E. M. MILLER & Co's**

**FINE BUGGIES.**

I respectfully ask the Public to call and see my Stock before purchasing elsewhere. My Stock is unusually large and well selected. A full line of the celebrated

**DESERT Carriage and Wagon COMPANY.**

SECOND SOUTH STREET.

One and a half blocks East of Main Street.

**BUILD ALL SIZES OF FARM AND SPRING WAGONS**

Fully Warranted for ONE YEAR.

Repairing in Woodwork, Blacksmithing, Painting, and Trimming.

**SATISFACTION GUARANTEED**

PRICES REASONABLE.

**J. WALKER, Manager.**

**LAND FOR SALE.**

**PUBLIC AUCTION.**

The Corporation of Salt Lake City will sell at Public Auction, to the highest bidder, on

**SATURDAY, APRIL 30, 1881.**

On the premises, the Land hereof known as the Bath House pasture, and embracing the following lots and parts of lots, situated in plot A, of Salt Lake City Surveys, viz:

Lots in 4, 5, 6 and 7, in Block 151.

Part of lots 1, 2, 3, 4, 5, 6, 7, and the whole of Lots 7 and 8, Block 152.

Lots 1, 2, 3, 4, 5, 6, 7, and 8, Block 153.

Lots 1, 2, 3, 4, 5, 6, 7, and 8, Block 154.

Lots 1, 2, 3, 4, 5, 6, 7, and 8, Block 155.

And more fully show in the following diagram.

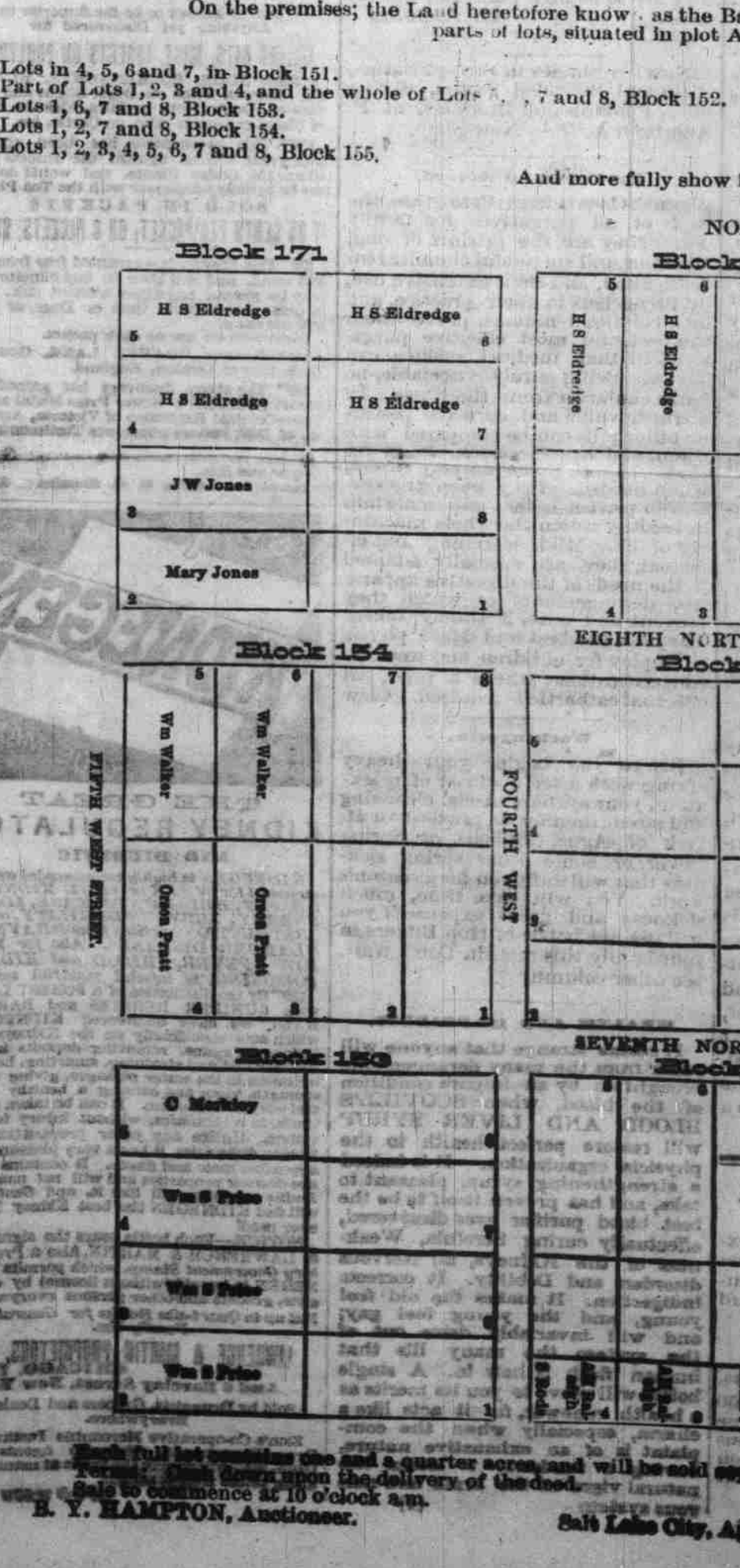

**ROYAL BAKING POWDER**

Absolutely Pure.

Made from Grape Cream Tartar. No other preparation makes such light, airy, tender, and delicious bread. Can be used by Dispensaries without fear of the risk resulting from heavy indigestible food. Sold by all Grocers.

ROYAL BAKING POWDER CO., New York.

**CHOICE MEATS!**

FRESH AND JUICY. THE BEST TRY market affords, always on hand at the Family Meat Market, just west of 10th St. Salt Lake City.

JAS. WILLIAMSON, Proprietor.

**OUR SPECIAL INDUCEMENTS**

Are offered every day to Cash Buyers, or any other Gifted Fellow, who will find the BAIN WAGON DEPOT.

The place to buy the Best, most Elegant and Substantial.

**Spring Wagons**

In the Market, also

**E. M. MILLER & Co's**

**FINE BUGGIES.**

I respectfully ask the Public to call and see my Stock before purchasing elsewhere. My Stock is unusually large and well selected. A full line of the celebrated

**DESERT Carriage and Wagon COMPANY.**

SECOND SOUTH STREET.

One and a half blocks East of Main Street.

**BUILD ALL SIZES OF FARM AND SPRING WAGONS**

Fully Warranted for ONE YEAR.

Repairing in Woodwork, Blacksmithing, Painting, and Trimming.

**SATISFACTION GUARANTEED**

PRICES REASONABLE.

**J. WALKER, Manager.**

**LAND FOR SALE.**

**PUBLIC AUCTION.**

The Corporation of Salt Lake City will sell at Public Auction, to the highest bidder, on

**SATURDAY, APRIL 30, 1881.**

On the premises, the Land hereof known as the Bath House pasture, and embracing the following lots and parts of lots, situated in plot A, of Salt Lake City Surveys, viz:

Lots in 4, 5, 6 and 7, in Block 151.

Part of lots 1, 2, 3, 4, 5, 6, 7, and the whole of Lots 7 and 8, Block 152.

Lots 1, 2, 3, 4, 5, 6, 7, and 8, Block 153.

Lots 1, 2, 3, 4, 5, 6, 7, and 8, Block 154.

Lots 1, 2, 3, 4, 5, 6, 7, and 8, Block 155.

And more fully show in the following diagram.

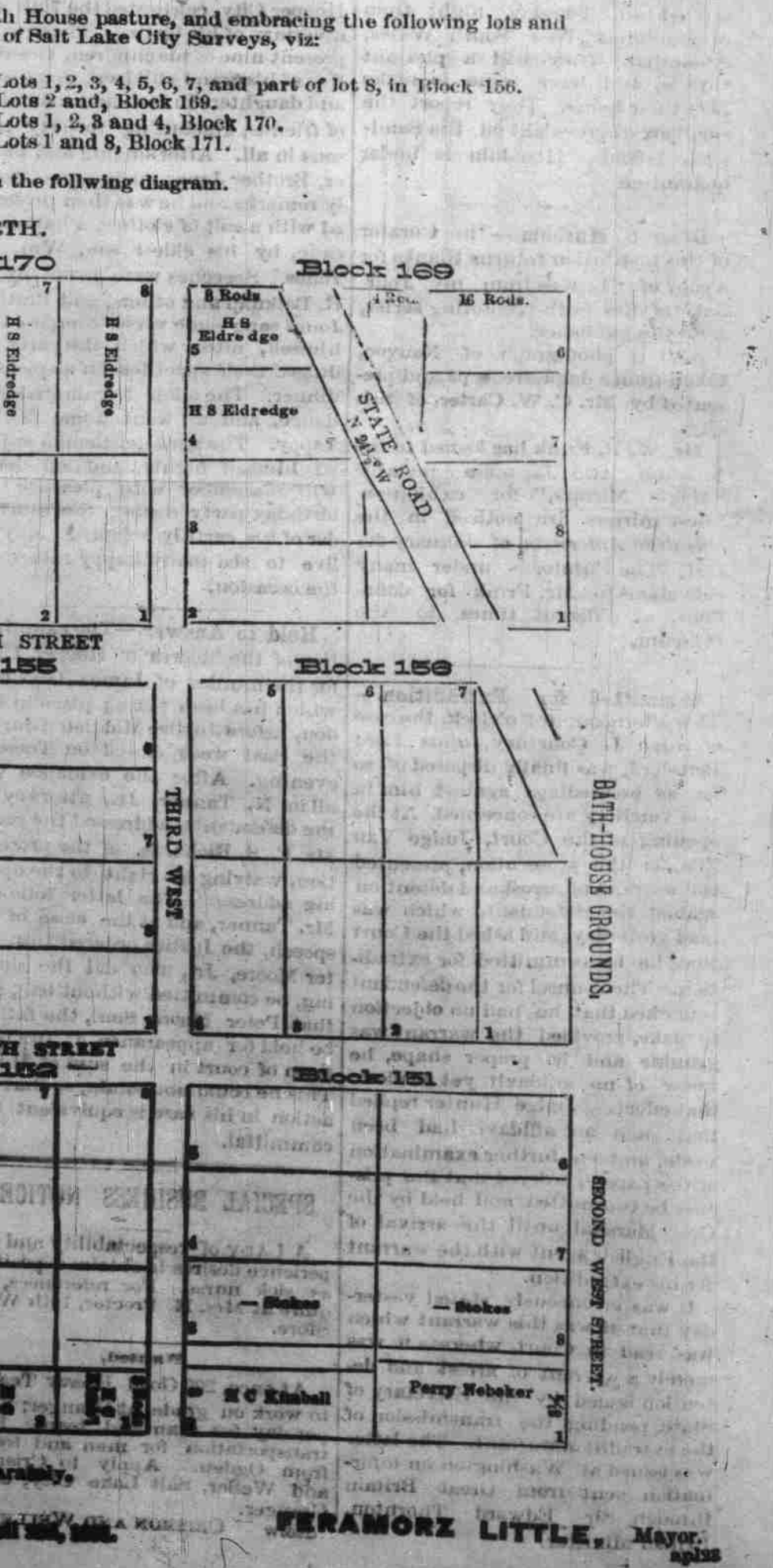

**FERAMORZ LITTLE, Mayor.**